



Trimble Catalyst DA2

GNSS RECEIVER

This guide provides an overview of important features and instructions to set up and operate the Trimble® Catalyst™ DA2 GNSS receiver and use it with a subscription to the Trimble Catalyst GNSS service. The receiver uses Bluetooth® technology to connect to a mobile device.

IN THE BOX

- Trimble Catalyst DA2 GNSS receiver, with USB power cable and push-fit mount
- Plastic bracket for battery mount
- Rubber straps (x2) for battery mount
- 5/8" x 11 threaded pole cap adapter (for push-fit mount)
- Quick Start Guide
- Trimble Hardware Warranty Card

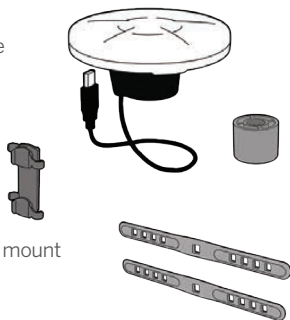

NOTE -The DA2 GNSS receiver requires power from a standard USB power pack, purchased separately.

SAFETY AND COMPLIANCE

Before you use the Trimble Catalyst DA2 GNSS receiver, refer to the safety documentation and compliance information at:

geospatial.trimble.com/DA2-Compliance



ATTACHING THE RECEIVER TO A SURVEYING POLE

The DA2 receiver has a convenient push-fit mount for simple attachment to any 1 ¼" diameter pole. A 5/8" x 11 thread adaptor for convenient installation/removal on standard mapping and surveying accessories is also included in the box.

NOTE - Additional mounting accessories are available from Trimble or third party accessory vendors. Contact your Trimble distribution partner for details. Optional Trimble accessories include:

- A DA2 mounting accessory kit that includes:
 - Short ¼" push-fit thread adapter for camera tripods and monopoles
 - Tall and short 5/8" x 11 lock-fit thread adapter for vehicle or high-vibration use
 - Replacement push-fit mounting kit
- Aluminium and carbon-fiber survey poles and accessories

For consistent and accurate results

- If using the receiver on a pole, ensure that it is flat and secure on the pole.
- If using the push-fit 5/8" x 11 thread adapter, ensure that the yellow plastic of the thread adapter is completely concealed in the push-fit mount.



- When you are ready to work, always position the receiver vertically above the point on the ground being surveyed or mapped.
- When setting the receiver height offset in the field application (if supported), measure from the bottom of the push-fit pole mount to the ground.
- When tracking satellites, try to always hold the receiver above head-height, level to the sky, and as vertical as possible to ensure best performance.

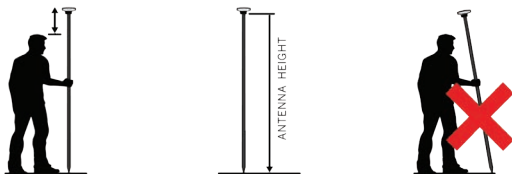

ASSEMBLING THE BATTERY MOUNT

The DA2 receiver is powered by USB. You can attach a standard off-the-shelf single-cell USB power pack to a survey rod using the supplied battery mounting bracket and rubber straps.

The supplied battery mount is designed to fit a variety of range pole and USB battery pack sizes.

To assemble the battery mount

1. Stretch the two rubber straps over the plastic bracket.

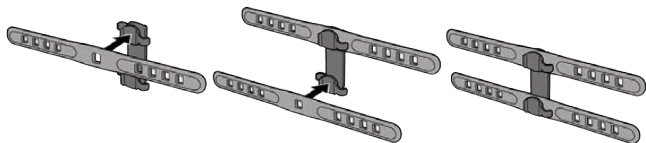

2. To attach the battery mount on a range pole, wrap the rubber straps around the pole and secure using the fastening clips.

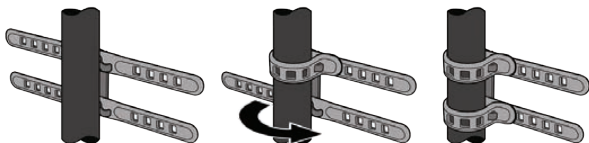

3. Attach a battery pack to the bracket using the clips on the other side.

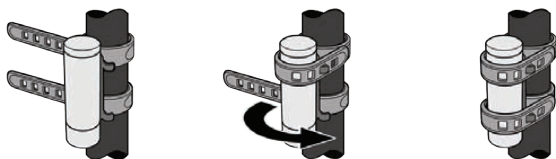

For maximum rain-resistance, mount the battery with the USB socket facing towards the ground.

Use the supplied USB cable to connect the receiver to the USB battery pack.

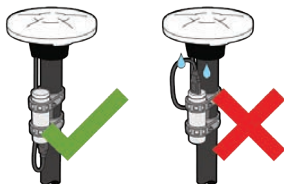

TURNING THE RECEIVER ON

Activate the USB battery pack and press the button on the bottom of the DA2 receiver to turn it on.

LED status

- Flashing blue = receiver is discoverable and ready to pair/connect.
- Solid blue = receiver is connected to your field app (on Android), or your device (on iOS).
- Red = Fault. Turn off the receiver, then turn it on again. If the fault indicator persists, contact your Trimble distributor.
- Yellow = receiver software update is in progress

TURNING THE RECEIVER OFF

Briefly press the power button or unplug the power cable.

If the receiver is not connected to a device, it will go to sleep automatically after about 20 minutes.

CONNECTING TO THE DA2 RECEIVER

The DA2 receiver uses Bluetooth to communicate with a phone or tablet device and software.

Connecting on Android

Connect directly to the DA2 receiver using any supported Trimble field app. Third party apps connect to the DA2 receiver using the Trimble Mobile Manager app, available from the Google Play Store.

Connecting on iPhone and iPad

Connect to the DA2 receiver under **Settings / Bluetooth**. Search for your DA2 serial number in the devices list, and tap on it to connect. Configure DA2 using your Trimble field app, or the Trimble Mobile Manager app, available from the Apple App Store.



CONFIGURING THE DA2 RECEIVER

Follow the instructions in your field app to configure the DA2 receiver real-time GNSS corrections and output settings.

RESETTING THE DA2 RECEIVER

Resetting the DA2 receiver will force the receiver to forget any previously connected Bluetooth devices. Press and hold the button on the receiver until the light turns off. The receiver will reset itself and turn off. Press the button again to restart it.

SUBSCRIBE TO THE CATALYST GNSS SERVICE

The DA2 receiver is designed for use with the Trimble Catalyst GNSS service. Purchase a subscription to the service from a Trimble Catalyst distribution partner. To find your nearest distributor, go to catalyst.trimble.com.

USING THE RECEIVER WITH A CATALYST GNSS SUBSCRIPTION

To use the Catalyst GNSS service on your phone or tablet, download the Trimble Mobile Manager app. This app manages your access to the Catalyst service, gives you access to configuration settings for the DA2 receiver, and enables other applications on your device to access and use the Catalyst GNSS receiver service.

1. Download the Trimble Mobile Manager app from the Apple App Store or Google Play and install it on your device.
2. Sign in with your Trimble ID to download your Catalyst subscription license.
3. Follow the instructions in Trimble Mobile Manager to configure Catalyst GNSS settings.
4. Share Catalyst GNSS positions directly from Trimble Mobile Manager, or if you are using a Catalyst enabled field app, connect to the DA2 receiver directly from your field app.

For more instructions, refer to the user documentation for your field app.

SERVICING AND CARE

The USB power cable and mounting features are the only serviceable / removable parts of the receiver. Do not attempt to disassemble the receiver. To clean the receiver, wipe clean with a moist cloth.

MORE INFORMATION

For more information about using the receiver and the Trimble Catalyst service, or for documentation in other languages, support and troubleshooting information, go to catalyst.trimble.com.



Made for

 iPhone | iPad

Use of the Made for Apple badge means that an accessory has been designed to connect specifically to the Apple product(s) identified in the badge and has been certified by the developer to meet Apple performance standards. Apple is not responsible for the operation of this device or its compliance with safety and regulatory standards.

Apple, iPad, and iPhone are trademarks of Apple Inc., registered in the U.S. and other countries.



Google, Google Play and other marks are trademarks of Google LLC.

© 2021, Trimble Inc. All rights reserved.
Trimble and the Globe & Triangle logo are trademarks of Trimble Inc., registered in the United States and in other countries. All other trademarks are the property of their respective owners.
Revision B. P/N 109696-00-ENG (06/21)



Trimble Germany
Am Prime Parc 11
65479 Raunheim
Germany

Trimble Inc.
10368 Westmoor Drive
Westminster CO 80021
USA

www.trimble.com

